

99,841 m<sup>2</sup>  
148,695.46 v<sup>2</sup>

Cuota = 00.017 cm<sup>2</sup>

RUBROS	DIST (M <sup>2</sup> )	VALOR
1-2	18,000	18,000
2-3	18,000	18,000
3-4	18,000	18,000
4-5	18,000	18,000
5-6	18,000	18,000
6-7	18,000	18,000
7-8	18,000	18,000
8-9	18,000	18,000
9-10	18,000	18,000
10-11	18,000	18,000
11-12	18,000	18,000
12-13	18,000	18,000
13-14	18,000	18,000
14-15	18,000	18,000
15-16	18,000	18,000
16-17	18,000	18,000
17-18	18,000	18,000
18-19	18,000	18,000
19-20	18,000	18,000
20-21	18,000	18,000
21-22	18,000	18,000
22-23	18,000	18,000
23-24	18,000	18,000
24-25	18,000	18,000
25-26	18,000	18,000
26-27	18,000	18,000
27-28	18,000	18,000
28-29	18,000	18,000
29-30	18,000	18,000
30-31	18,000	18,000
31-32	18,000	18,000
32-33	18,000	18,000
33-34	18,000	18,000
34-35	18,000	18,000
35-36	18,000	18,000
36-37	18,000	18,000
37-38	18,000	18,000
38-39	18,000	18,000
39-40	18,000	18,000
40-41	18,000	18,000
41-42	18,000	18,000
42-43	18,000	18,000
43-44	18,000	18,000
44-45	18,000	18,000
45-46	18,000	18,000
46-47	18,000	18,000
47-48	18,000	18,000
48-49	18,000	18,000
49-50	18,000	18,000
50-51	18,000	18,000
51-52	18,000	18,000
52-53	18,000	18,000
53-54	18,000	18,000
54-55	18,000	18,000
55-56	18,000	18,000
56-57	18,000	18,000
57-58	18,000	18,000
58-59	18,000	18,000
59-60	18,000	18,000
60-61	18,000	18,000
61-62	18,000	18,000
62-63	18,000	18,000
63-64	18,000	18,000
64-65	18,000	18,000
65-66	18,000	18,000
66-67	18,000	18,000
67-68	18,000	18,000
68-69	18,000	18,000
69-70	18,000	18,000
70-71	18,000	18,000
71-72	18,000	18,000
72-73	18,000	18,000
73-74	18,000	18,000
74-75	18,000	18,000
75-76	18,000	18,000
76-77	18,000	18,000
77-78	18,000	18,000
78-79	18,000	18,000
79-80	18,000	18,000
80-81	18,000	18,000
81-82	18,000	18,000
82-83	18,000	18,000
83-84	18,000	18,000
84-85	18,000	18,000
85-86	18,000	18,000
86-87	18,000	18,000
87-88	18,000	18,000
88-89	18,000	18,000
89-90	18,000	18,000
90-91	18,000	18,000
91-92	18,000	18,000
92-93	18,000	18,000
93-94	18,000	18,000
94-95	18,000	18,000
95-96	18,000	18,000
96-97	18,000	18,000
97-98	18,000	18,000
98-99	18,000	18,000
99-100	18,000	18,000

POLIG. LOTE	NUM.	M T S T	V R S T	POLIG. LOTE	NUM.	M T S T	V R S T	
1	1	21.8	27.4	48.8	10	2.0	2.0	2.0
2	2	1.8	1.8	1.8	11	2.0	2.0	2.0
3	3	1.8	1.8	1.8	12	2.0	2.0	2.0
4	4	1.8	1.8	1.8	13	2.0	2.0	2.0
5	5	1.8	1.8	1.8	14	2.0	2.0	2.0
6	6	1.8	1.8	1.8	15	2.0	2.0	2.0
7	7	1.8	1.8	1.8	16	2.0	2.0	2.0
8	8	1.8	1.8	1.8	17	2.0	2.0	2.0
9	9	1.8	1.8	1.8	18	2.0	2.0	2.0
10	10	1.8	1.8	1.8	19	2.0	2.0	2.0
11	11	1.8	1.8	1.8	20	2.0	2.0	2.0
12	12	1.8	1.8	1.8	21	2.0	2.0	2.0
13	13	1.8	1.8	1.8	22	2.0	2.0	2.0
14	14	1.8	1.8	1.8	23	2.0	2.0	2.0
15	15	1.8	1.8	1.8	24	2.0	2.0	2.0
16	16	1.8	1.8	1.8	25	2.0	2.0	2.0
17	17	1.8	1.8	1.8	26	2.0	2.0	2.0
18	18	1.8	1.8	1.8	27	2.0	2.0	2.0
19	19	1.8	1.8	1.8	28	2.0	2.0	2.0
20	20	1.8	1.8	1.8	29	2.0	2.0	2.0
21	21	1.8	1.8	1.8	30	2.0	2.0	2.0
22	22	1.8	1.8	1.8	31	2.0	2.0	2.0
23	23	1.8	1.8	1.8	32	2.0	2.0	2.0
24	24	1.8	1.8	1.8	33	2.0	2.0	2.0
25	25	1.8	1.8	1.8	34	2.0	2.0	2.0
26	26	1.8	1.8	1.8	35	2.0	2.0	2.0
27	27	1.8	1.8	1.8	36	2.0	2.0	2.0
28	28	1.8	1.8	1.8	37	2.0	2.0	2.0
29	29	1.8	1.8	1.8	38	2.0	2.0	2.0
30	30	1.8	1.8	1.8	39	2.0	2.0	2.0
31	31	1.8	1.8	1.8	40	2.0	2.0	2.0
32	32	1.8	1.8	1.8	41	2.0	2.0	2.0
33	33	1.8	1.8	1.8	42	2.0	2.0	2.0
34	34	1.8	1.8	1.8	43	2.0	2.0	2.0
35	35	1.8	1.8	1.8	44	2.0	2.0	2.0
36	36	1.8	1.8	1.8	45	2.0	2.0	2.0
37	37	1.8	1.8	1.8	46	2.0	2.0	2.0
38	38	1.8	1.8	1.8	47	2.0	2.0	2.0
39	39	1.8	1.8	1.8	48	2.0	2.0	2.0
40	40	1.8	1.8	1.8	49	2.0	2.0	2.0
41	41	1.8	1.8	1.8	50	2.0	2.0	2.0
42	42	1.8	1.8	1.8	51	2.0	2.0	2.0
43	43	1.8	1.8	1.8	52	2.0	2.0	2.0
44	44	1.8	1.8	1.8	53	2.0	2.0	2.0
45	45	1.8	1.8	1.8	54	2.0	2.0	2.0
46	46	1.8	1.8	1.8	55	2.0	2.0	2.0
47	47	1.8	1.8	1.8	56	2.0	2.0	2.0
48	48	1.8	1.8	1.8	57	2.0	2.0	2.0
49	49	1.8	1.8	1.8	58	2.0	2.0	2.0
50	50	1.8	1.8	1.8	59	2.0	2.0	2.0
51	51	1.8	1.8	1.8	60	2.0	2.0	2.0
52	52	1.8	1.8	1.8	61	2.0	2.0	2.0
53	53	1.8	1.8	1.8	62	2.0	2.0	2.0
54	54	1.8	1.8	1.8	63	2.0	2.0	2.0
55	55	1.8	1.8	1.8	64	2.0	2.0	2.0
56	56	1.8	1.8	1.8	65	2.0	2.0	2.0
57	57	1.8	1.8	1.8	66	2.0	2.0	2.0
58	58	1.8	1.8	1.8	67	2.0	2.0	2.0
59	59	1.8	1.8	1.8	68	2.0	2.0	2.0
60	60	1.8	1.8	1.8	69	2.0	2.0	2.0
61	61	1.8	1.8	1.8	70	2.0	2.0	2.0
62	62	1.8	1.8	1.8	71	2.0	2.0	2.0
63	63	1.8	1.8	1.8	72	2.0	2.0	2.0
64	64	1.8	1.8	1.8	73	2.0	2.0	2.0
65	65	1.8	1.8	1.8	74	2.0	2.0	2.0
66	66	1.8	1.8	1.8	75	2.0	2.0	2.0
67	67	1.8	1.8	1.8	76	2.0	2.0	2.0
68	68	1.8	1.8	1.8	77	2.0	2.0	2.0
69	69	1.8	1.8	1.8	78	2.0	2.0	2.0
70	70	1.8	1.8	1.8	79	2.0	2.0	2.0
71	71	1.8	1.8	1.8	80	2.0	2.0	2.0
72	72	1.8	1.8	1.8	81	2.0	2.0	2.0
73	73	1.8	1.8	1.8	82	2.0	2.0	2.0
74	74	1.8	1.8	1.8	83	2.0	2.0	2.0
75	75	1.8	1.8	1.8	84	2.0	2.0	2.0
76	76	1.8	1.8	1.8	85	2.0	2.0	2.0
77	77	1.8	1.8	1.8	86	2.0	2.0	2.0
78	78	1.8	1.8	1.8	87	2.0	2.0	2.0
79	79	1.8	1.8	1.8	88	2.0	2.0	2.0
80	80	1.8	1.8	1.8	89	2.0	2.0	2.0
81	81	1.8	1.8	1.8	90	2.0	2.0	2.0
82	82	1.8	1.8	1.8	91	2.0	2.0	2.0
83	83	1.8	1.8	1.8	92	2.0	2.0	2.0
84	84	1.8	1.8	1.8	93	2.0	2.0	2.0
85	85	1.8	1.8	1.8	94	2.0	2.0	2.0
86	86	1.8	1.8	1.8	95	2.0	2.0	2.0
87	87	1.8	1.8	1.8	96	2.0	2.0	2.0
88	88	1.8	1.8	1.8	97	2.0	2.0	2.0
89	89	1.8	1.8	1.8	98	2.0	2.0	2.0
90	90	1.8	1.8	1.8	99	2.0	2.0	2.0
91	91	1.8	1.8	1.8	100	2.0	2.0	2.0

DESCRIPCION	M T S T	V R S T
AREA UTIL	73,936.82	105,768.52
AREA DE ACCESOS	18,508.82	26,461.93
ZONA VERDE	3,572.50	5,111.53
ACOMUNAL EQUIP. SOC.	3,735.45	5,344.68
AREA DE CANALETA	8.00	12.59
AREA TOTAL	99,841.08	142,695.25

**Nota:**  
El lote nro del poligono 21 queda  
Anulado por no cumplir con el area  
mínimo.

PROPIETARIO:  
JUANA TROYA DE IRAHETA

CONTENIDO:  
DISTRIBUCION DE LOTES.

LEVANTO:  
DIBUJO: MARINA ESTELA MENDOZA MORENO

ESC. 1: 1000 14 de Mayo/1,986

UBICACION: CANTON EL PORRILLO, JURISDICCION DE  
TEGOLUCA, DEPARTAMENTO DE SAN VICENTE,  
SOBRE CARRETERA LITORAL.

RESPONSABLE:  
BORJA-GOMEZ, S.A. DE CV

No. DE LOTES  
**313**

COPIA ARCHIVO VMVDU  
0000001

VICEMINISTERIO DE VIVIENDA Y  
DESARROLLO URBANO  
OFICINA DE LICENCIAS Y ESTUDIOS DE LEGALIZACION  
Escriba: 1163  
Fiscal: 03001, 2011

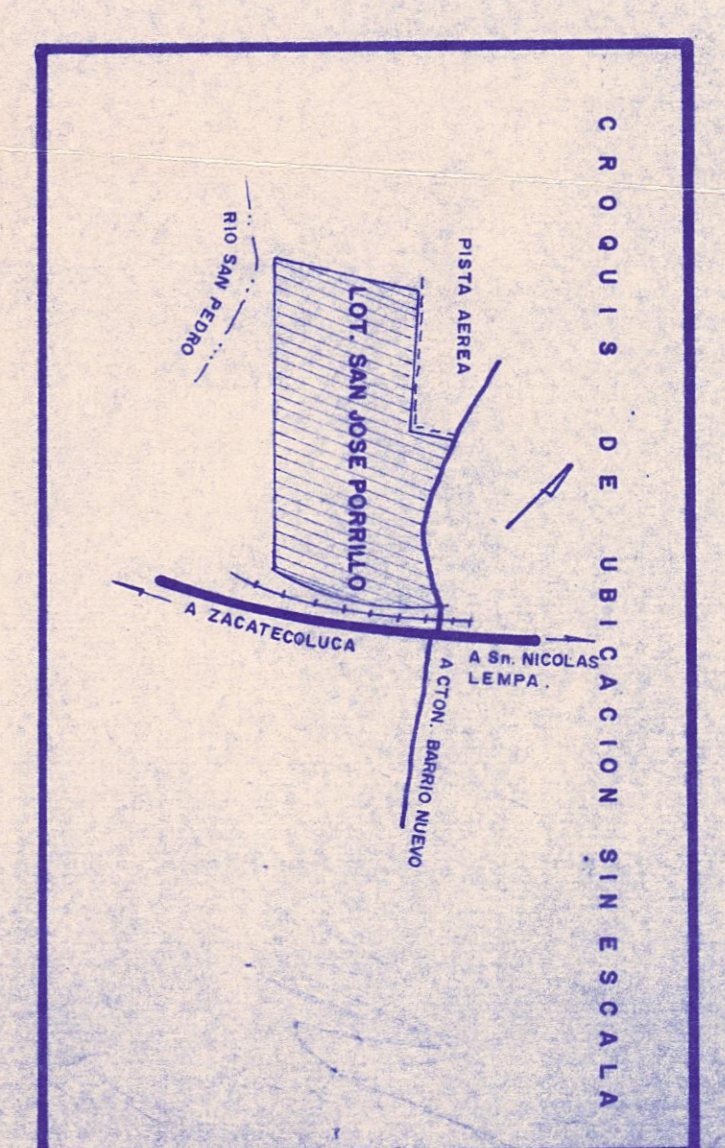
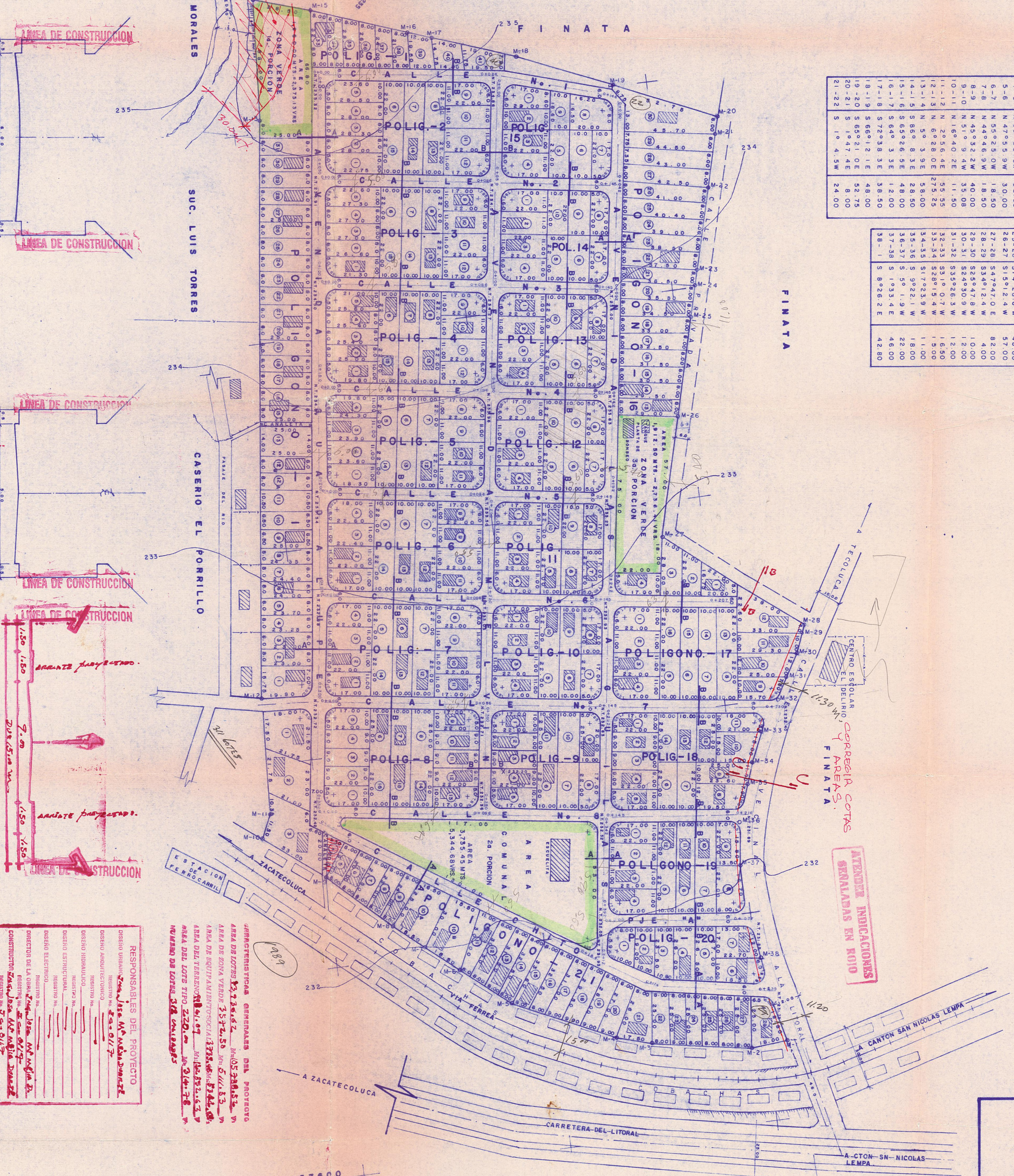

SEALOS:  
\* Revision Plano Preliminar: por caso  
Deseo Comprobar con el Plan de Lotes  
Muestrales.

Se trata de una parcelación  
existente desarrollada en 1980.